



# GB-200/300/400

## HEAD MOTION SYSTEMS

**GB-200/300** series are the state of the industry Head Motion Systems for in line printing directly onto your package. Utilizing a single Platen Printer or several, these Head Motion Systems automatically print multiple rows of packages in both web directions: with the web, across the web or a combination of both. It's the perfect solution for all multi-lane applications. From simple date codes, to nutritional facts, to product description, to handling instructions, The Head Motion Systems allow a single printer to do the work of three, six or even twelve printers.

In-line reciprocating imprinting system

Ideal for everything from date codes to nutritional information

Applicable to virtually any substrate

Retrofits to all horizontal form fill and seal packaging machines

Capable of printing X, Y, and X and Y axis

Fully programmable for packaging machine tooling changes

Saves ink type and set-up time

Suitable for all multi-row packaging applications

Capable of printing on both the forming and non forming webs.

Uses all printers from 2"x2" to 4"x4" wet ink to hot stamp



**GREYDON**  
I N C

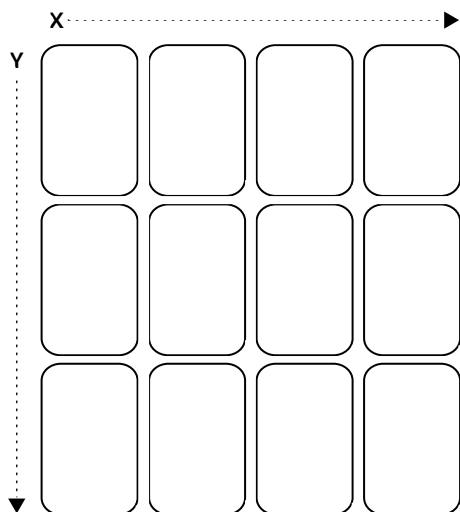

PRINT MULTIPLE ROWS OF PACKAGES WITH  
A SINGLE PLATEN PRINTER.

### Printing Solutions

Greydon's Head Motions Systems give you many options to solve your printing application.

GB-200 series for printing across the web

GB-300 series for printing across the web

GB-400 series for printing in both web directions.

Greydon can help you determine which system is the most effective and economical solution to your particular application.



### Service and Support

Greydon carries in stock, a complete supply of inks and type for all of your printing needs. Our parts department provides immediate access to a complete inventory of replacement parts and accessories. In addition, our Technical Service Department is always on call to help troubleshoot problems and help deliver fast reliable service.

### Print Technology

Greydon's Head Motion Systems give you many options as to which type of printer you may use.

GC-220 2x2 print area

GC-240 2x4 print area

GC-420 4x2 print area

GC-440 4x4 print area

We can also adapt these systems to the wide variety of Hot Stamp printers as well.

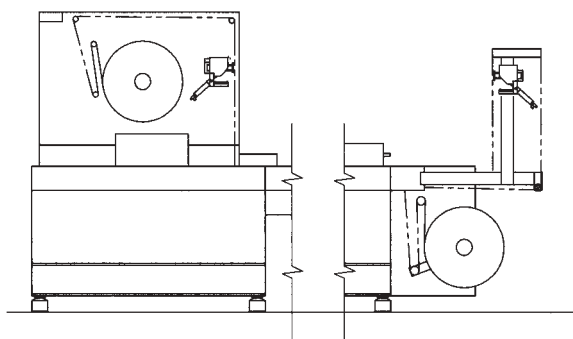

### Options

Greydon's Head Motion Systems can be mounted to print on the Non Forming Web, the Forming Web as well as on top of our Rotary Printer for complete package and information printing. This combination offers the option of two color printing.

391 Greendale Rd.

York, PA 17403

Phone 717.848.3875

Fax 717.843.6435

E-mail  
info@greydon.com  
www.greydon.com



**GREYDON**  
I N C