



GB-200/300/400

HEAD MOTION SYSTEMS

GB-200/300 series are the state of the industry Head Motion Systems for in line printing directly onto your package. Utilizing a single Flatbed Printer or several, these Head Motion Systems automatically print multiple rows of packages in both web directions: with the web, across the web or a combination of both. It's the perfect solution for all multi-lane applications. From simple date codes, to nutritional facts, to product description, to handling instructions, The Head Motion Systems allow a single printer to do the work of three, six or even twelve printers.

**In-line reciprocating
imprinting system**

**Ideal for everything
from date codes
to nutritional
information**

**Applicable to
virtually any
substrate**

**Retrofits to all
horizontal form fill
and seal packaging
machines**

**Capable of printing
X, Y, and X and Y
axis**

**Fully programmable
for packaging
machine tooling
changes**

**Saves ink type
and set-up time**

**Suitable for all
multi-row packaging
applications**

**Capable of printing
on both the forming
and non forming
webs.**

**Uses all printers
from 2"x2" to 4"x4"
wet ink to hot stamp**



**GREYDON
INC.**

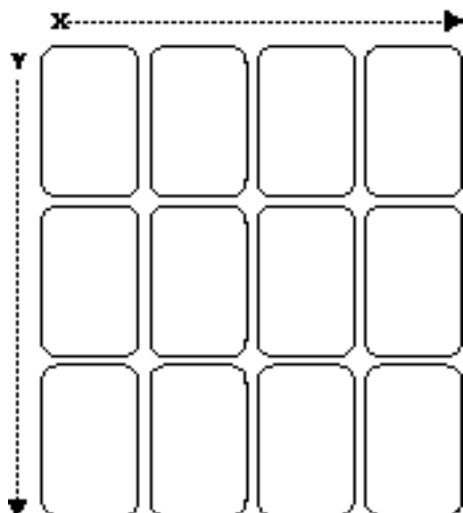

PRINT MULTIPLE ROWS OF PACKAGES WITH
A SINGLE PLATEN PRINTER.

Printing Solutions

Greydon's Head Motion Systems give you many options to solve your printing application.

GB-200 series for printing across the web

GB-300 series for printing across the web

GB-400 series for printing in both web directions.

Greydon can help you determine which system is the most effective and economical solution to your particular application.



Service and Support

Greydon carries in stock, a complete supply of inks and type for all of your printing needs. Our parts department provides immediate access to a complete inventory of replacement parts and accessories. In addition, our Technical Service Department is always on call to help troubleshoot problems and help deliver fast reliable service.

Print Technology

Greydon's Head Motion Systems give you many options as to which type of printer you may use.

GC-220 2x2 print area

GC-240 2x4 print area

GC-420 4x2 print area

GC-440 4x4 print area

We can also adapt these systems to the wide variety of Hot Stamp printers as well.

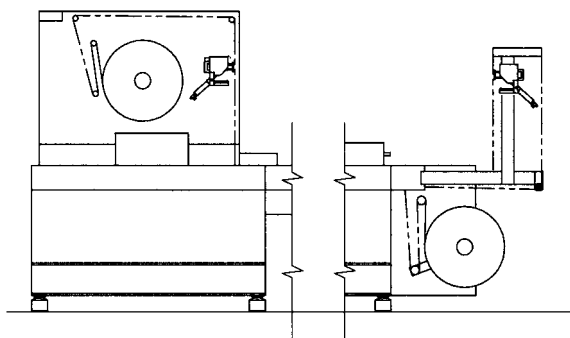

Options

Greydon's Head Motion Systems can be mounted to print on the Non Forming Web, the Forming Web as well as on top of our Rotary Printer for complete package and information printing. This combination offers the option of two color printing.

391 Greendale Rd.

York, PA 17403

Phone 717.848.3875

Fax 717.843.6435

E-mail
greydoninc.@msn.com



GREYDON
INC.